

# To and from the airport

**The Copenhagen Metro runs to and from Copenhagen Airport. The metro is the fastest and cheapest way of getting from the airport to the City, Frederiksberg and Vanløse.**

The metro station is in Terminal 3, at the very end. On arrival you need to go past the airline check-in counters (SAS, Lufthansa, etc.) and up the escalators. Terminal 2 is a short walk away. With departures to and from the airport as often as every four minutes, you don't need to plan anything in advance. The trip from the airport to the City takes just fourteen minutes.

## Prices

You can purchase tickets for public transport from the metro ticket machines located in all metro stations, including the airport. You can also buy tickets from the ticket counter in Terminal 3.



# Road map

## NOITS 15 – 16 May 2015



Hotel Ibsen Vendersgade 23



UCPH, Department of Economics, Building 35, near Gammeltoftsgade 17



Restaurant HÖST  
Nørre Farimagsgade 41



Restaurant WIP  
Sankt Peders Stræde 34



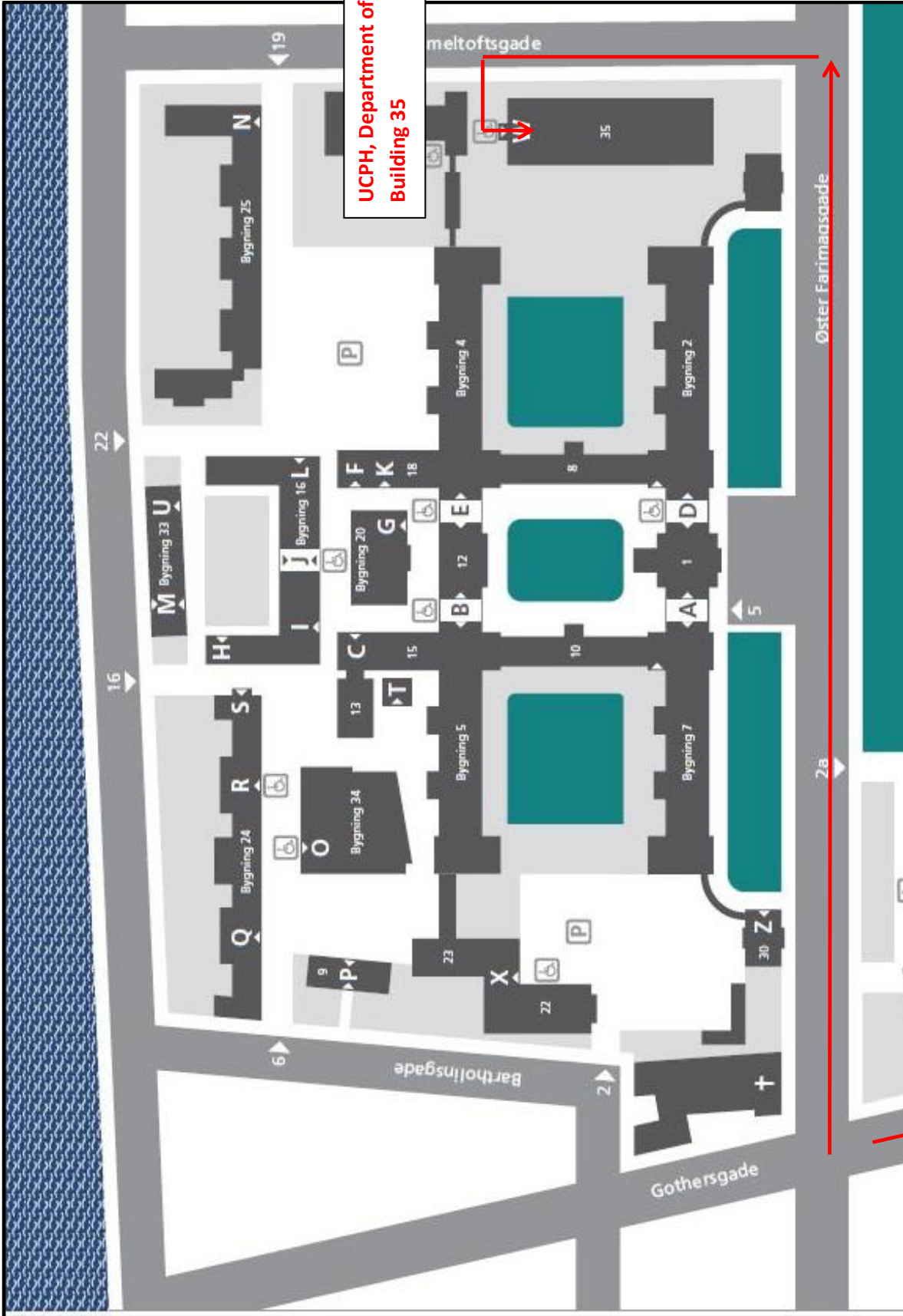

**UCPH, Department of Economics  
Building 35**

